

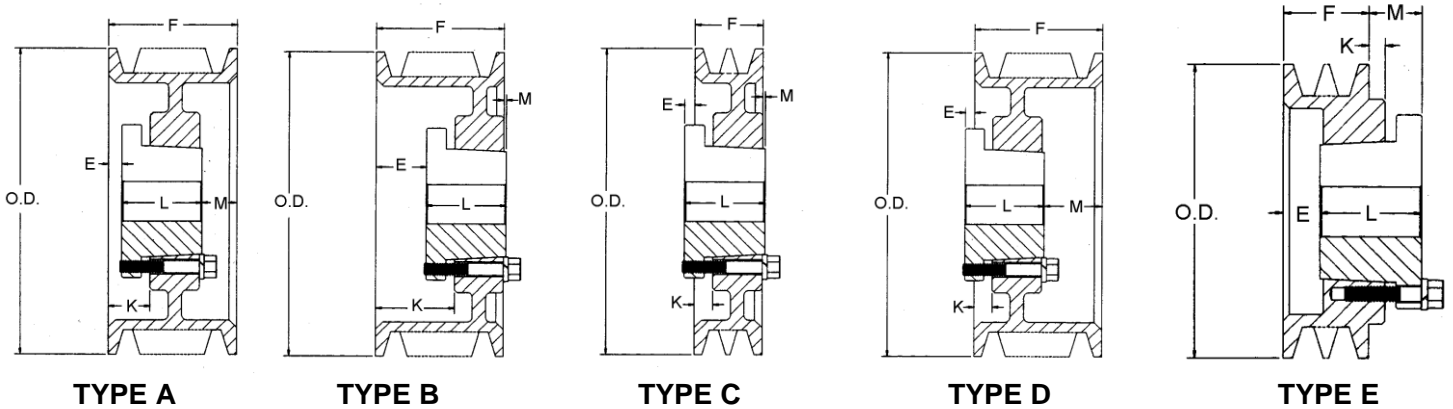

# 5V stock sheave dimensions super wedge sheave drives



## Part Number Explanation

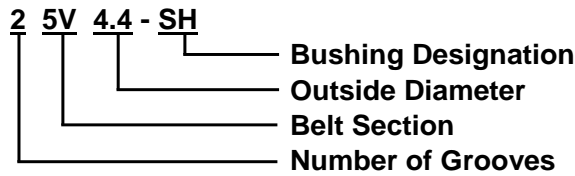

Figure Following Letter in Column Headed "TYPE" in Table Below Indicates Sheave Construction  
1 - Solid, No Web. 2 - Web. 3 - Arms

O.D.	PART NUMBER	2 GROOVE F = 1-11/16							PART NUMBER	3 GROOVE F = 2-3/8						
		BUSH	TYPE	E	K	L	M	WT		BUSH	TYPE	E	K	L	M	WT
4.40	25V4.4	SH	A1	3/16	11/16	1-1/4	1/4	4.0	35V4.4	SDS	E1	1-5/8	0	1-5/16	9/16	5.2
4.65	25V4.65	SDS	E1	3/4	3/16	1-5/16	3/8	4.3	35V4.65	SDS	E1	1-5/8	0	1-5/16	9/16	5.8
4.90	25V4.9	SDS	A1	1/8	11/16	1-5/16	1/4	4.8	35V4.9	SDS	A1	1/2	1-1/16	1-5/16	9/16	5.9
5.20	25V5.2	SDS	A1	1/8	11/16	1-5/16	1/4	5.4	35V5.2	SDS	A1	1/2	1-1/16	1-5/16	9/16	6.6
5.50	25V5.5	SDS	A1	1/8	11/16	1-5/16	1/4	6.1	35V5.5	SDS	A1	1/2	1-1/16	1-5/16	9/16	7.4
5.90	25V5.9	SDS	A1	1/8	11/16	1-5/16	1/4	6.8	35V5.9	SDS	A1	1/2	1-1/16	1-5/16	9/16	8.2
6.30	25V6.3	SK	D1	3/16	7/16	1-7/8	0	9.6	35V6.3	SK	A1	7/16	1-1/16	1-7/8	1/16	11.2
6.70	25V6.7	SK	D1	3/16	7/16	1-7/8	0	11.0	35V6.7	SK	A1	7/16	1-1/16	1-7/8	1/16	12.7
7.10	25V7.1	SK	D1	3/16	7/16	1-7/8	0	13.0	35V7.1	SF	B1	3/8	1	2	0	15.0
7.50	25V7.5	SK	D1	3/16	7/16	1-7/8	0	14.5	35V7.5	SF	B1	3/8	1	2	0	16.8
8.00	25V8.0	SK	D1	3/16	7/16	1-7/8	0	16.5	35V8.0	SF	B1	3/8	1	2	0	18.6
8.50	25V8.5	SK	D2	3/16	7/16	1-7/8	0	14.5	35V8.5	SF	B1	3/8	1	2	0	20.7
9.00	25V9.0	SK	D2	3/16	7/16	1-7/8	0	16.0	35V9.0	SF	B2	3/8	1	2	0	20.9
9.25	25V9.25	SK	D2	3/16	7/16	1-7/8	0	17.0	35V9.25	SF	B2	3/8	1	2	0	21.6
9.75	25V9.75	SK	D3	3/16	7/16	1-7/8	0	14.5	35V9.75	SF	B2	3/8	1	2	0	22.8
10.30	25V10.3	SK	D3	3/16	7/16	1-7/8	0	15.5	35V10.3	SF	B2	3/8	1	2	0	24.3
10.90	25V10.9	SK	D3	3/16	7/16	1-7/8	0	17.0	35V10.9	SF	B3	3/8	1	2	0	26.2
11.30	25V11.3	SK	D3	3/16	7/16	1-7/8	0	18.3	35V11.3	SF	B3	3/8	1	2	0	24.2
11.80	25V11.8	SK	D3	3/16	7/16	1-7/8	0	19.0	35V11.8	SF	B3	3/8	1	2	0	25.0
12.50	25V12.5	SF	C3	3/16	7/16	2	1/8	22.0	35V12.5	E	C3	1/8	3/4	2-5/8	1/8	36.0
13.20	25V13.2	SF	C3	3/16	7/16	2	1/8	24.0	35V13.2	E	C3	1/8	3/4	2-5/8	1/8	38.0
14.00	25V14.0	SF	C3	3/16	7/16	2	1/8	27.0	35V14.0	E	C3	1/8	3/4	2-5/8	1/8	46.0
15.00	25V15.0	SF	C3	3/16	7/16	2	1/8	28.0	35V15.0	E	C3	1/8	3/4	2-5/8	1/8	44.0
16.00	25V16.0	SF	C3	3/16	7/16	2	1/8	29.0	35V16.0	E	C3	1/8	3/4	2-5/8	1/8	45.0
18.70	25V18.7	SF	C3	3/16	7/16	2	1/8	39.0	35V18.7	E	C3	1/8	3/4	2-5/8	1/8	55.0
21.20	25V21.2	SF	C3	3/16	7/16	2	1/8	43.0	35V21.2	E	C3	1/8	3/4	2-5/8	1/8	62.0
23.60	25V23.6	E	C3	1/8	3/4	2-5/8	13/16	61.0	35V23.6	E	C3	1/8	3/4	2-5/8	1/8	75.0
28.00	25V28.0	E	C3	1/8	3/4	2-5/8	13/16	77.5	35V28.0	E	C3	1/8	3/4	2-5/8	1/8	85.0
31.50									35V31.5	F	C3	7/16	9/16	3-5/8	13/16	130.0
37.50									35V37.5	F	C3	7/16	9/16	3-5/8	13/16	143.0
50.00									35V50.0	F	C3	7/16	9/16	3-5/8	13/16	218.0

NOTE: Weight includes bushing with average bore size.

All Dimensions in Inches



# 5V stock sheave dimensions super wedge sheave drives

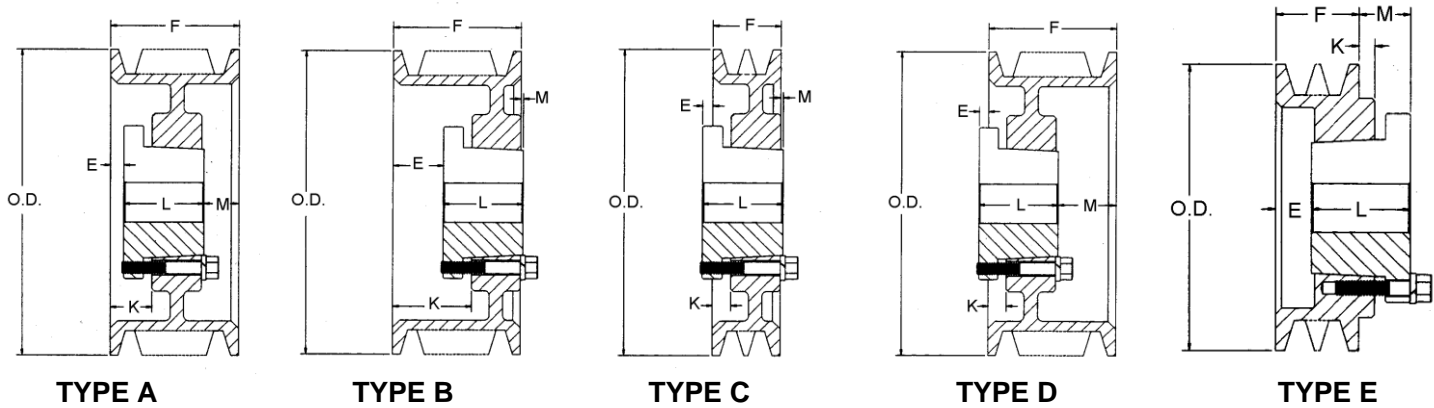

## Part Number Explanation

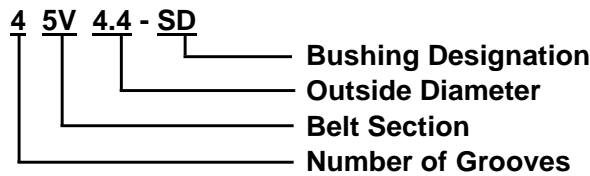

Figure Following Letter in Column Headed "TYPE" in Table Below Indicates Sheave Construction  
1 - Solid, No Web. 2 - Web. 3 - Arms

O.D.	PART NUMBER	4 GROOVE F = 3-1/16							PART NUMBER	5 GROOVE F = 3-3/4						
		BUSH	TYPE	E	K	L	M	WT		BUSH	TYPE	E	K	L	M	WT
4.40	45V4.4	SD	E1	1-13/16	0	1-13/16	9/16	6.3	55V4.4	SD	E1	2-1/2	0	1-13/16	9/16	7.3
4.65	45V4.65	SD	E1	1-13/16	0	1-13/16	9/16	7.1	55V4.65	SD	E1	2-1/2	0	1-13/16	9/16	8.1
4.90	45V4.9	SD	A1	3/4	1-5/16	1-13/16	1/2	7.7	55V4.9	SD	A1	3/4	1-5/16	1-13/16	1-3/16	8.7
5.20	45V5.2	SD	A1	3/4	1-5/16	1-13/16	1/2	8.7	55V5.2	SD	A1	3/4	1-5/16	1-13/16	1-3/16	9.9
5.50	45V5.5	SD	A1	3/4	1-5/16	1-13/16	1/2	9.8	55V5.5	SD	A1	3/4	1-5/16	1-13/16	1-3/16	11.1
5.90	45V5.9	SD	A1	3/4	1-5/16	1-13/16	1/2	11.1	55V5.9	SK	A1	11/16	1-5/16	1-7/8	1-3/16	12.6
6.30	45V6.3	SK	A1	11/16	1-5/16	1-7/8	1/2	12.7	55V6.3	SK	A1	11/16	1-5/16	1-7/8	1-3/16	14.3
6.70	45V6.7	SK	A1	11/16	1-5/16	1-7/8	1/2	14.3	55V6.7	SF	A1	11/16	1-5/16	2	1-1/16	16.6
7.10	45V7.1	SF	A1	7/16	1-1/16	2	5/8	16.7	55V7.1	SF	A1	3/4	1-3/8	2	1	18.8
7.50	45V7.5	SF	A1	7/16	1-1/16	2	5/8	18.8	55V7.5	SF	A1	3/4	1-3/8	2	1	20.8
8.00	45V8.0	E	B1	9/16	1-7/16	2-5/8	1/8	27.3	55V8.0	E	A1	7/8	1-3/4	2-5/8	1/4	29.1
8.50	45V8.5	E	B1	9/16	1-7/16	2-5/8	1/8	29.8	55V8.5	E	A1	7/8	1-3/4	2-5/8	1/4	32.2
9.00	45V9.0	E	B1	9/16	1-7/16	2-5/8	1/8	32.9	55V9.0	E	A1	7/8	1-3/4	2-5/8	1/4	35.3
9.25	45V9.25	E	B1	9/16	1-7/16	2-5/8	1/8	34.8	55V9.25	E	A1	7/8	1-3/4	2-5/8	1/4	37.5
9.75	45V9.75	E	B2	9/16	1-7/16	2-5/8	1/8	34.0	55V9.75	E	A2	7/8	1-3/4	2-5/8	1/4	38.0
10.30	45V10.3	E	B2	9/16	1-7/16	2-5/8	1/8	36.3	55V10.3	E	A2	7/8	1-3/4	2-5/8	1/4	40.3
10.90	45V10.9	E	B2	9/16	1-7/16	2-5/8	1/8	40.0	55V10.9	E	A2	7/8	1-3/4	2-5/8	1/4	44.5
11.30	45V11.3	E	B2	9/16	1-7/16	2-5/8	1/8	40.0	55V11.3	E	A2	7/8	1-3/4	2-5/8	1/4	43.6
11.80	45V11.8	E	B2	9/16	1-7/16	2-5/8	1/8	41.5	55V11.8	E	A2	7/8	1-3/4	2-5/8	1/4	44.5
12.50	45V12.5	E	B3	9/16	1-7/16	2-5/8	1/8	42.5	55V12.5	E	A3	7/8	1-3/4	2-5/8	1/4	55.0
13.20	45V13.2	E	B3	9/16	1-7/16	2-5/8	1/8	44.0	55V13.2	E	A3	7/8	1-3/4	2-5/8	1/4	58.0
14.00	45V14.0	E	B3	9/16	1-7/16	2-5/8	1/8	45.0	55V14.0	E	A3	7/8	1-3/4	2-5/8	1/4	59.8
15.00	45V15.0	E	B3	9/16	1-7/16	2-5/8	1/8	49.8	55V15.0	E	A3	7/8	1-3/4	2-5/8	1/4	60.5
16.00	45V16.0	E	B3	9/16	1-7/16	2-5/8	1/8	51.0	55V16.0	E	A3	7/8	1-3/4	2-5/8	1/4	67.0
18.70	45V18.7	E	A3	3/8	1-1/4	2-5/8	1/16	65.0	55V18.7	F	B3	5/16	1-5/16	3-5/8	3/16	88.0
21.20	45V21.2	E	A3	3/8	1-1/4	2-5/8	1/16	71.0	55V21.2	F	B3	5/16	1-5/16	3-5/8	3/16	107.0
23.60	45V23.6	F	C3	1/8	7/8	3-5/8	7/16	98.0	55V23.6	F	B3	5/16	1-5/16	3-5/8	3/16	112.0
28.00	45V28.0	F	C3	1/8	7/8	3-5/8	7/16	114.0	55V28.0	F	B3	5/16	1-5/16	3-5/8	3/16	132.0
31.50	45V31.5	F	C3	1/8	7/8	3-5/8	7/16	142.0	55V31.5	J	C3	3/16	1	4-1/2	9/16	178.0
37.50	45V37.5	F	C3	1/8	7/8	3-5/8	7/16	171.0	55V37.5	J	C3	3/16	1	4-1/2	9/16	220.0
50.00	45V50.0	J	C3	1/2	11/16	4-1/2	15/16	253.0	55V50.0	J	C3	3/16	1	4-1/2	9/16	275.0

NOTE: Weight includes bushing with average bore size.

All Dimensions in Inches



# 5V stock sheave dimensions super wedge sheave drives

Figure Following Letter in Column Headed "TYPE" in Table Below Indicates Sheave Construction  
1 - Solid, No Web. 2 - Web. 3 - Arms

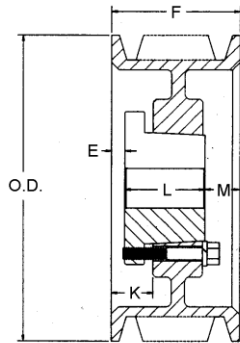

**TYPE A**

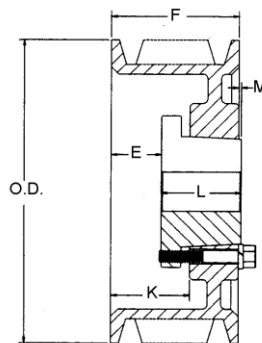

**TYPE B**

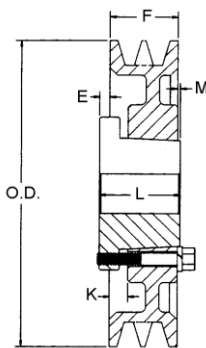

**TYPE C**

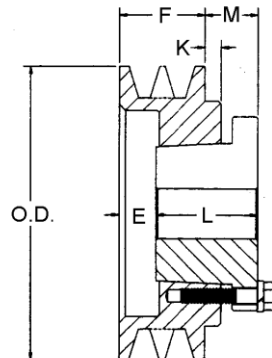

**TYPE E**

O.D.	PART NUMBER	6 GROOVE							WT
		BUSH	TYPE	F = 4-7/16					
				E	K	L	M		
4.40	65V4.4	SD	E1	3-3/16	0	1-13/16	9/16	8.2	
4.65	65V4.65	SD	E1	3-3/16	0	1-13/16	9/16	9.1	
4.90	65V4.9	SD	A1	3/4	1-5/16	1-13/16	1-7/8	9.7	
5.20	65V5.2	SD	A1	3/4	1-5/16	1-13/16	1-7/8	11.0	
5.50	65V5.5	SD	A1	3/4	1-5/16	1-13/16	1-7/8	12.4	
5.90	65V5.9	SK	A1	11/16	1-5/16	1-7/8	1-7/8	14.0	
6.30	65V6.3	SK	A1	11/16	1-5/16	1-7/8	1-7/8	15.8	
6.70	65V6.7	SF	A1	1	1-5/8	2	1-7/16	18.2	
7.10	65V7.1	SF	A1	1	1-5/8	2	1-7/16	20.5	
7.50	65V7.5	SF	A1	1	1-5/8	2	1-7/16	23.5	
8.00	65V8.0	E	A1	1-1/8	2	2-5/8	11/16	32.0	
8.50	65V8.5	E	A1	1-1/8	2	2-5/8	11/16	34.5	
9.00	65V9.0	E	A1	1-1/8	2	2-5/8	11/16	38.0	
9.25	65V9.25	E	A1	1-1/8	2	2-5/8	11/16	40.0	
9.75	65V9.75	E	A1	1-1/8	2	2-5/8	11/16	44.3	
10.30	65V10.3	E	A2	1-1/8	2	2-5/8	11/16	43.5	
10.90	65V10.9	E	A2	1-1/8	2	2-5/8	11/16	48.3	
11.30	65V11.3	E	A2	1-1/8	2	2-5/8	11/16	47.8	
11.80	65V11.8	E	A2	1-1/8	2	2-5/8	11/16	49.0	
12.50	65V12.5	F	B2	1-1/16	2-1/16	3-5/8	1/4	68.0	
13.20	65V13.2	F	B2	1-1/16	2-1/16	3-5/8	1/4	68.0	
14.00	65V14.0	F	B2	1-1/16	2-1/16	3-5/8	1/4	73.0	
15.00	65V15.0	F	B3	1-1/16	2-1/16	3-5/8	1/4	75.0	
16.00	65V16.0	F	B3	1-1/16	2-1/16	3-5/8	1/4	91.0	
18.70	65V18.7	F	A3	5/16	1-5/16	3-5/8	1/2	95.0	
21.20	65V21.2	F	A3	5/16	1-5/16	4-1/2	1/2	116.0	
23.60	65V23.6	J	B3	1/8	1-5/16	4-1/2	3/16	134.0	
28.00	65V28.0	J	B3	1/8	1-5/16	4-1/2	3/16	153.0	
31.50	65V31.5	J	B3	1/8	1-5/16	4-1/2	3/16	200.0	
37.50	65V37.5	J	B3	1/8	1-5/16	4-1/2	3/16	235.0	
50.00	65V50.0	M	C3	15/16	1/2	6-3/4	1-3/8	363.0	

O.D.	PART NUMBER	8 GROOVE							PART NUMBER	10 GROOVE								
		BUSH	TYPE	F = 5-13/16				BUSH		TYPE	F = 7-3/16							
				E	K	L	M				WT	E	K	L	M	WT		
7.10	85V7.1	SF	A1	1-1/2	2-1/8	2	2-5/16	24.0										
7.50	85V7.5	SF	A1	1-1/2	2-1/8	2	2-5/16	27.3										
8.00	85V8.0	E	A1	1-5/8	2-1/2	2-5/8	1-9/16	35.5	105V8.0	E	A1	2-3/8	3-1/4	2-5/8	2-3/16	41.8		
8.50	85V8.5	E	A1	1-5/8	2-1/2	2-5/8	1-9/16	39.0	105V8.5	E	A1	2-3/8	3-1/4	2-5/8	2-3/16	44.0		
9.00	85V9.0	E	A1	1-5/8	2-1/2	2-5/8	1-9/16	43.0	105V9.0	F	A1	2-5/16	3-5/16	3-5/8	1-1/4	57.0		
9.25	85V9.25	F	A1	1-9/16	2-9/16	3-5/8	5/8	55.0	105V9.25	F	A1	2-5/16	3-5/16	3-5/8	1-1/4	60.0		
9.75	85V9.75	F	A1	1-9/16	2-9/16	3-5/8	5/8	57.5	105V9.75	F	A1	2-5/16	3-5/16	3-5/8	1-1/4	64.0		
10.30	85V10.3	F	A1	1-9/16	2-9/16	3-5/8	5/8	60.0	105V10.3	F	A1	2-5/16	3-5/16	3-5/8	1-1/4	66.0		
10.90	85V10.9	F	A1	1-9/16	2-9/16	3-5/8	5/8	65.0	105V10.9	F	A1	2-5/16	3-5/16	3-5/8	1-1/4	72.0		
11.30	85V11.3	F	A1	1-9/16	2-9/16	3-5/8	5/8	76.9	105V11.3	F	A1	2-5/16	3-5/16	3-5/8	1-1/4	84.0		
11.80	85V11.8	F	A2	1-9/16	2-9/16	3-5/8	5/8	67.0	105V11.8	F	A2	2-5/16	3-5/16	3-5/8	1-1/4	80.0		
12.50	85V12.5	F	A2	1-9/16	2-9/16	3-5/8	5/8	76.0	105V12.5	J	A2	2-3/8	3-9/16	4-1/2	5/16	111.0		
13.20	85V13.2	F	A2	1-9/16	2-9/16	3-5/8	5/8	76.8	105V13.2	J	A2	2-3/8	3-9/16	4-1/2	5/16	105.0		
14.00	85V14.0	F	A2	1-9/16	2-9/16	3-5/8	5/8	77.0	105V14.0	J	A2	2-3/8	3-9/16	4-1/2	5/16	108.0		
15.00	85V15.0	F	A3	1-9/16	2-9/16	3-5/8	5/8	85.0	105V15.0	J	A2	2-3/8	3-9/16	4-1/2	5/16	120.0		
16.00	85V16.0	F	A3	1-9/16	2-9/16	3-5/8	5/8	90.0	105V16.0	J	A3	2-3/8	3-9/16	4-1/2	5/16	160.0		
18.70	85V18.7	J	A3	3/8	1-9/16	4-1/2	15/16	174.0	105V18.7	J	A3	3/8	1-9/16	4-1/2	2-5/16	140.0		
21.20	85V21.2	J	A3	3/8	1-9/16	4-1/2	15/16	163.0	105V21.2	J	A3	3/8	1-9/16	4-1/2	2-5/16	185.0		
23.60	85V23.6	J	A3	3/8	1-9/16	4-1/2	15/16	158.0	105V23.6	M	B3	1/2	1-15/16	6-3/4	1/16	235.0		
28.00	85V28.0	J	A3	3/8	1-9/16	4-1/2	15/16	180.0	105V28.0	M	B3	1/2	1-15/16	6-3/4	1/16	260.0		
31.50	85V31.5	M	B3	1/2	1-15/16	6-3/4	1-7/16	300.0	105V31.5	M	B3	1/2	1-15/16	6-3/4	1/16	325.0		
37.50	85V37.5	M	B3	1/2	1-15/16	6-3/4	1-7/16	342.0	105V37.5	M	B3	1/2	1-15/16	6-3/4	1/16	375.0		
50.00	85V50.0	M	B3	1/2	1-15/16	6-3/4	1-7/16	420.0	105V50.0	M	B3	1/2	1-15/16	6-3/4	1/16	472.0		

NOTE: Weight includes bushing with average bore size.

All Dimensions in Inches